

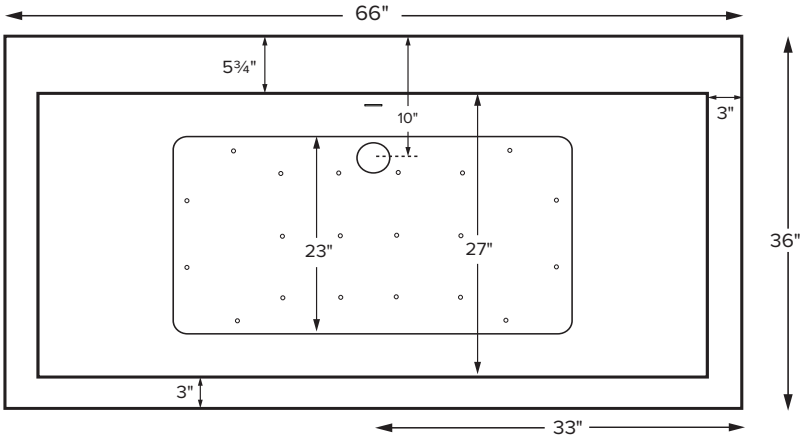

Available as a freestanding model or finished on 1, 2 or 3 sides for various installation applications.

Kahlo 2
with Sculpted Finish®

MODEL 142A	
66" x 36" x 22.5"	
FREESTANDING or ALCOVE 90 gal to overflow	
Acrylic CXL®	DoloMatte®
170 lbs / 77 kg	<SOAKER> 191 lbs / 87 kg
Filling this tub to the maximum may require an above average size or dedicated water heater.	



Features a flat 5 3/4" deck surface on the drain side for mounting faucetry and an integrated overflow. Shown as Air Bath

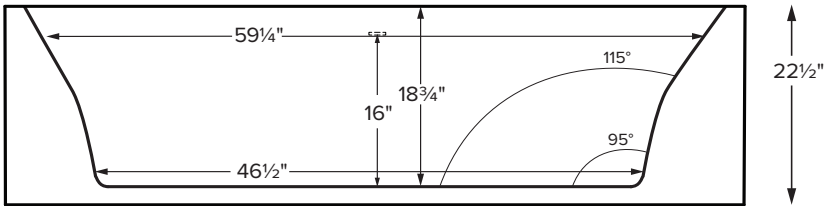

ELECTRICAL COMPONENTS & SPECIFICATIONS		
Hydrotherapy Package	Components Included	GFCI/110V
Microbubbles	Microbubbles pump	1-15 amp
Air Massage	heated blower	1-15 amp
Microbubbles with Air	Microbubbles pump, heated blower	1-20 amp
Air Massage Elite	heated blower, chromatherapy	1-15 amp
Microbubbles with Air Elite	Microbubbles pump, heated blower, chromatherapy	2-15 amp

Electrical requirements may change with the addition of optional therapy components. See specific option details or installation information, CSA Certified C/US; B45.5/IAPMO ANSI Z124.1 and ANSI 112.19.7

See the Installation & Operation Manual for more details.
MTI's Customer Service: Monday-Friday 8am-6pm EST
800-783-8827 or service@mtibaths.com

- IMPORTANT ORDERING & INSTALLATION INFORMATION**
- Before ordering or installing, please consider future access to equipment.
 - Unless ordering Sculpted Finish on 4 sides, please include a diagram specifying which sides will need to be finished, along with location of optional tile flange(s).
 - Integrated overflow with direct connect toe tap drain in chrome included. See manual for details.
 - When ordering an air bath, the air blower must be remote mounted.
 - Microbubbles system components must be installed on a non-Sculpted Finish side. Components will extend beyond the perimeter of the tub. Call MTI for specific details regarding the desired installation before placing the order.
 - Radiance placed on floor locations will affect placement of air jets.
 - Hydrotherapy equipment may ship loose for remote installation. See package content on the following page for details. Specifications and configurations are subject to change without notice.
 - All tubs are compliant with ASTM C 1028-07 coefficient of friction. DoloMatte meets ANSI A137.1/A326.3 coefficient of friction and AS HB198:2014 slip tests.

• Options and accessories may be packaged inside the tub crate. Always check packaging before discarding.
• All product measurements are ±1/2".
• Specifications and configurations are subject to change without notice.
• Measurements herein supersede all others published prior to publication date below.



Kahlo 2
with Sculpted Finish®
MODEL 142A
66" x 36" x 22.5"

Hydrotherapy Packages	Package Contents	Sculpted Finish Sides	Acrylic CXL®		DoloMatte®	
			Part #	MSRP	Part #	MSRP
Soaker	Soaking bath - no jets, pre-leveled foam base, integrated slotted overflow with toe tap drain	4-sides sculpted	S142A4	\$8,645	S142D4	\$9,725
		3-sides sculpted	S142A3	\$8,000	S142D3	\$8,945
		2-sides sculpted	S142A2	\$6,465	S142D2	\$7,275
		1-side sculpted	S142A1	\$6,090	S142D1	\$6,765
Microbubbles	1 infusion port, microbubbles pump, pre-leveled foam base, integrated slotted overflow with toe tap drain	4-sides sculpted	n/a	n/a	n/a	n/a
		3-sides sculpted	M142A3	\$10,990	M142D3	\$11,935
		2-sides sculpted	M142A2	\$9,455	M142D2	\$10,265
		1-side sculpted	M142A1	\$9,080	M142D1	\$9,755
Air Massage	20 air jets, heated air blower, pre-leveled foam base, integrated slotted overflow with toe tap drain	4-sides sculpted	AST142A4	\$11,930	AST142D4	\$13,010
		3-sides sculpted	AST142A3	\$11,285	AST142D3	\$12,230
		2-sides sculpted	AST142A2	\$9,750	AST142D2	\$10,560
		1-side sculpted	AST142A1	\$9,375	AST142D1	\$10,050
Air Massage Elite	30 air jets, heated air blower, Chromatherapy LED lighting, Spa Mode, pre-leveled foam base, integrated slotted overflow with toe tap drain	4-sides sculpted	AE142A4	\$13,640	AE142D4	\$14,720
		3-sides sculpted	AE142A3	\$12,995	AE142D3	\$13,940
		2-sides sculpted	AE142A2	\$11,460	AE142D2	\$12,270
		1-side sculpted	AE142A1	\$11,085	AE142D1	\$11,760
Microbubbles with Air Massage	1 infusion port, microbubbles pump, 20 air jets, heated air blower, pre-leveled foam base, integrated slotted overflow with toe tap drain	4-sides sculpted	n/a	n/a	n/a	n/a
		3-sides sculpted	ASTM142A3	\$13,735	ASTM142D3	\$14,680
		2-sides sculpted	ASTM142A2	\$12,200	ASTM142D2	\$13,010
		1-side sculpted	ASTM142A1	\$11,825	ASTM142D1	\$12,500
Microbubbles with Air Massage Elite	1 infusion port, microbubbles pump, 30 air jets, heated air blower, Chromatherapy LED lighting, Spa Mode, pre-leveled foam base, integrated slotted overflow with toe tap drain	4-sides sculpted	n/a	n/a	n/a	n/a
		3-sides sculpted	AEM142A3	\$15,355	AEM142D3	\$16,300
		2-sides sculpted	AEM142A2	\$13,820	AEM142D2	\$14,630
		1-side sculpted	AEM142A1	\$13,445	AEM142D1	\$14,120

Microbubbles system components must be installed on a non-Sculpted Finish® side.

Components will extend beyond the perimeter of the tub. Call MTI for specific details regarding the desired installation before placing order.

For more customized applications, additional hydrotherapies may possibly be integrated in Sculpted Finish® tubs, depending on the types of therapy and the installation application. Visit mtibaths.com or call MTI at 800.783.8827.

RECOMMENDED SENSORY THERAPIES

Chromatherapy

(LE) **\$800** underwater lighting
2 LED lights included

Audiotherapy

(STEREOBT) **\$1,390** 2 transducers
with bluetooth and amplifier
(BTREMOTE) **\$600** bluetooth remote

(STEREOH202) **\$1,575** 4 transducers
amplifier not included

Thermaltherapy

(RAD100) **\$1,595** Radiance®
2 heated zones included



For more information on options and accessories go to Acrylic Tub Options on mtibaths.com

Options <i>Must be ordered at time of purchase.</i>	
Standard Color White (CWH) gloss Acrylic CXL, matte DoloMatte	
Textured, Slip-Resistant Bottom (TXTBTM) \$105 DoloMatte® exceeds ANSI A137.1/A326.3 and AS HB198 slip tests.	
Ozonator (OZONE) \$515	
Virtual Spout high-flow integrated tub filler (FPMJ) \$450 <i>Must be located on same side as tub deck. Specify location when ordering.</i>	
Installation Options <i>Must be ordered at time of purchase.</i>	
Tile Flange Factory Installed rigid ABS	
1 Side (TFK1) \$175	IMPORTANT: <i>Must specify flange location(s) on order of Factory-Installed Flange.</i>
2 Sides (TFK2) \$185	
3 Sides (TFK3) \$200	
Field Install Kit (TFKNI) \$185 Includes rigid ABS & adhesive	

Accessories	
Pillows from \$180	
Teak Bath Mat (TKMAT3018) \$815 <i>Custom sizes also available. Contact MTI for details and pricing.</i>	
Teak Tub Tray Slatted (TK-TRAY1) \$500 Solid (TK-TRAY2) \$570	
Floor-Mounted High-Flow Tub Filler Contemporary Chrome (FILLC) \$1,480 Brushed Nickel (FILLBN) \$1,710	

Drains & Overflow Kits *Must be ordered at time of purchase*

Integrated Overflow with Toe Tap

Slotted Overflow

PVC drain - Chrome (SLOTIOC) included

Finish Upcharge

White (SLOTIOWHU) **\$65**

Brushed Nickel (SLOTIOBNU) **\$65**

Polished Nickel (SLOTIOPNU) **\$105**

Round Overflow

Chrome (RIOBC) may substitute slotted overflow

Finish Upcharge

White (RIOWH) **\$120**

Brushed Nickel (RIOBN) **\$120**

Polished Nickel (RIOPN) **\$120**

Brass Tailpiece (WIOBS) **\$85**

May be ordered separately