

California Faucets®

Poetto®

PULL DOWN KITCHEN FAUCET - 2 BEND SPOUT

**Features**

- Over 28 finishes including 13 PVD finishes
- All brass construction
- 360° rotating spout
- Magnetic docking secures sprayhead into spout
- One button brass spray head has dual function aerated or spray mode
- Spray jets have easy-to-clean surface that withstands mineral build-up
- Quiet polymer-braided hose with rotating joint at sprayhead allows for smooth and non-binding use
- Ceramic disc cartridge
- Max flow rate: 1.8 gpm (6.8 L/m)

CF-K50-103-XX

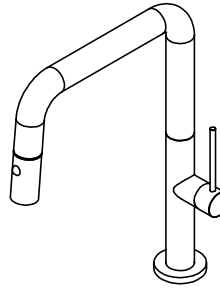

CF-K50-103-ST-ZZ SHOWN

XX = DENOTES HANDLE STYLE

**Codes/Standards Applicable**

Meets or exceeds the following at date of manufacture:

- ASME A112.18.1/CSA B125.1
- NSF 61 and NSF 372
- CEC / DOE
- Commonwealth of MA
- ADA Compliant

DIMENSIONS (in.)[mm]			
XX HANDLE	A	B	C
ST	7 1/4 [184]	13 3/16 [96]	13 3/16 [97]
BST	7 1/4 [184]	13 3/16 [96]	13 3/16 [97]
SST	7 6/8 [175]	3 3/4 [95]	7 1/16 [87]
BSST	7 6/8 [175]	3 3/4 [95]	7 1/16 [87]

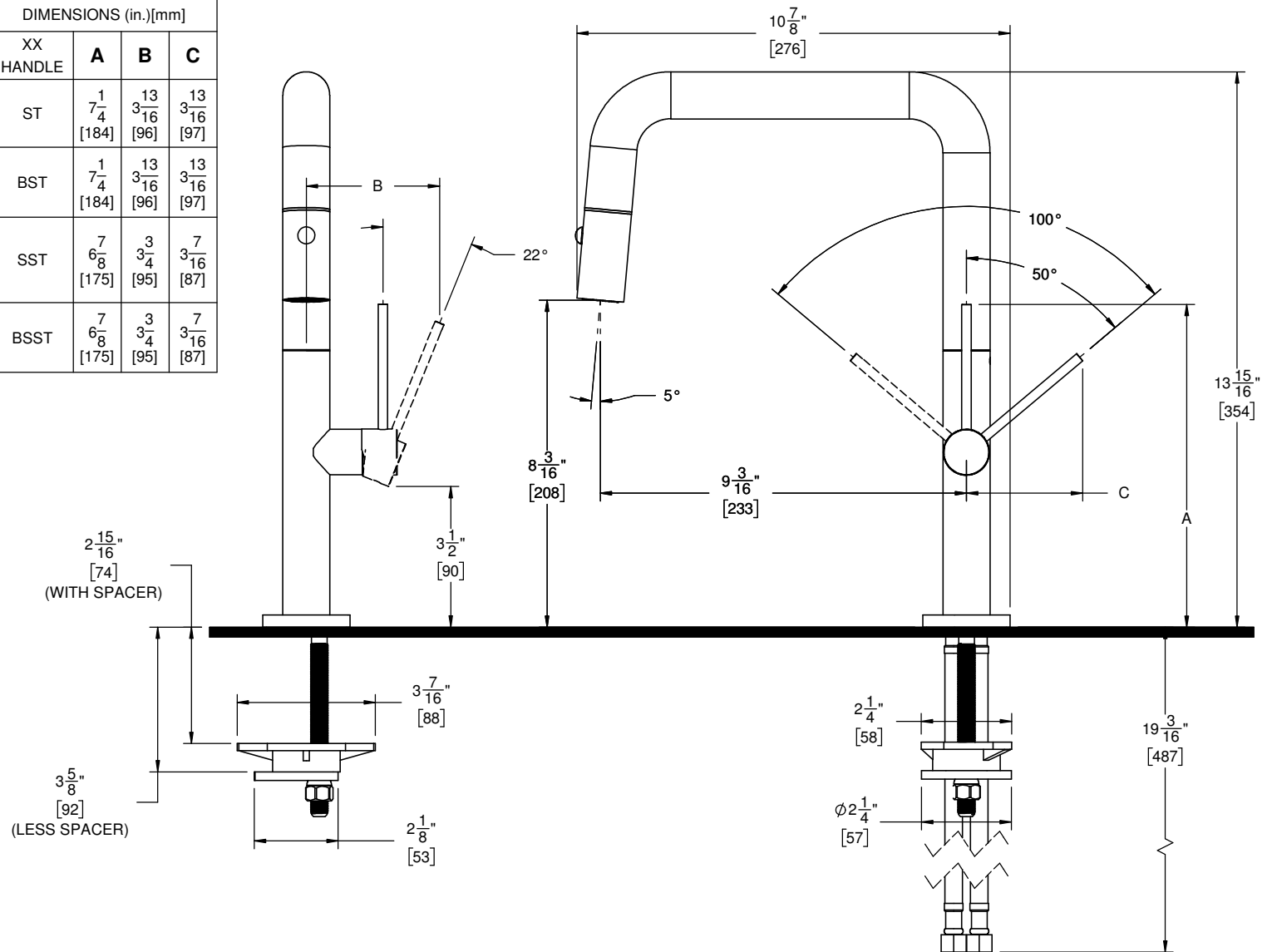

THROUGH-HOLE SPECIFICATIONS		
MIN	RECOMMENDED	MAX
φ 1-1/4"	φ 1-3/8"	φ 1-3/8"

SPECIFICATIONS SUBJECT TO CHANGE WITHOUT NOTICE

ALL DIMENSIONS SHOWN TO NEAREST 1/16"  
[ALL DIMENSIONS SHOWN TO NEAREST 1MM]"